

easyLine



easyLine F Item No.: 2400 0020
 easyLine R Item No.: 2400 0022

The all-rounder for your OR.

Chassis

- High-grade 5-arm aluminum pedestal
- Excellent handling characteristics thanks to smooth-running double castors
- Optionally available with braking double castors
- Supports loads up to 130 kilograms



Seating system

Round seat

- Ultra comfortable, large-surface seat part, thick seat cushion with high adaptability
- Comfort upholstery
- Durable, easy-care seat cover made of medical-grade artificial leather to meet the highest OR requirements



Flexibility

Variants

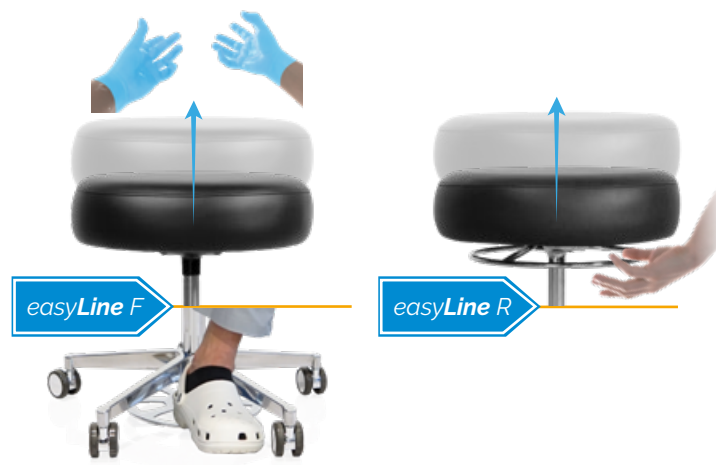

Technical specifications

Lifting column

- Height adjustment easyLine F 580 – 760 mm
 easyLine R 575 – 760 mm

Chassis

- Five legged chassis ø 585 mm
- Castors ø 65 mm

Round seat

- D x W x H 400 x 400 x 105 mm

Weight

- easyLine F 9.8 kg
 easyLine R 7.6 kg

Max. load

130 kg

Subject to technical modifications.

- Sterile, comfortable height adjustment via foottriggered gas pressure spring (easyLine F)
- Classic seat height adjustment via hand-operated ring (easyLine R) underneath the seat
- Flexible height adjustment from 58 to 76 cm (easyLine F) and 57.5 to 76 cm (easyLine R)

Standard color

black

Item No.: 3037 0235



Round seat

"PeriLine" Page 105

Components



easyLine F
Item No.: 2400 0020



easyLine R
Item No.: 2400 0022



assistLine
Item No.: 2400 0015



Double rimmed castor,
65 mm, with braking function

Item No.: 3351 0040

“PeriLine”



Product Specification

- Without Phthalates
- Biocompatibility: cytotoxicity (EN ISO 10 993-5) and epicutaneous test (EN ISO 10 993-10)
- Urine resistance
- Blood resistance
- Resistance to perspiration
- Resistance to spitting
- Light fastness
- Color fastness to rubbing
- Flame retardant

<i>surgiForce</i>	Comfort seat	2600 0004
<i>surgiForce light</i>	Comfort seat	2600 0006
<i>surgiTrend</i>	Comfort seat	2200 0012
<i>surgiLine</i>	Comfort seat	2200 0013
<i>assistPro F</i>		2400 0005
<i>assistPro H</i>		2400 0009
<i>easyPro F</i>		2400 0010
<i>easyPro R</i>		2400 0013
<i>easyLine F</i>		2400 0020
<i>easyLine R</i>		2400 0022

+ Item No.: 3037 0...

				
kastanie 015817 Item No.:240	light brown 016037 Item No.:239	creme 015812 Item No.:225	weiß 010881 Item No.:224	stein 015813 Item No.:236
				
saphir 015814 Item No.:231	delft 010766 Item No.:241	antistatisch schwarz Item No.:223	schwarz 011499 Item No.:235	anthracit 016046 Item No.:234
				
azur 015815 Item No.:230	aubergine 016041 Item No.:229	lavendel 016042 Item No.:228	rot 010878 Item No.:238	orange 016040 Item No.:237
				
kiwi 015816 Item No.:232	lime green 016043 Item No.:232	lemon 016039 Item No.:226	safran 010879 Item No.:227	

The colors displayed on your device may differ slightly from the original colors. If you wish to receive original color charts, please contact us at info@ufsk-osys.com.

Upgrade your OR to perfection.



eyeForce



500 XLE



500 XLE comfort



500 XLS



500 ECO



400 XL



motionLine



motionLine-E



surgiForce



surgiForce light



surgiTrend



surgiLine



stayClean



stayClean roll



stayClean kick bucket



supportLine



assistTrend



assistPro F



assistPro H



easyPro F



easyPro R



easyLine F



easyLine R



assistLine

CONTACT US



UFSK
INTERNATIONAL

OSYS

UFSK-International OSYS GmbH
Kirchhoffstraße 1
93055 Regensburg
Germany

Tel. +49 (0) 941 78862 15
Fax +49 (0) 941 78862 35
E-Mail info@ufsk-osys.com
Web ufsk-osys.com

MADE IN GERMANY
Design | Construction | Manufacturing